

STEEL

ROS - SS - 011
Shower Rose and Arm

TECHNICAL SPECIFICATIONS

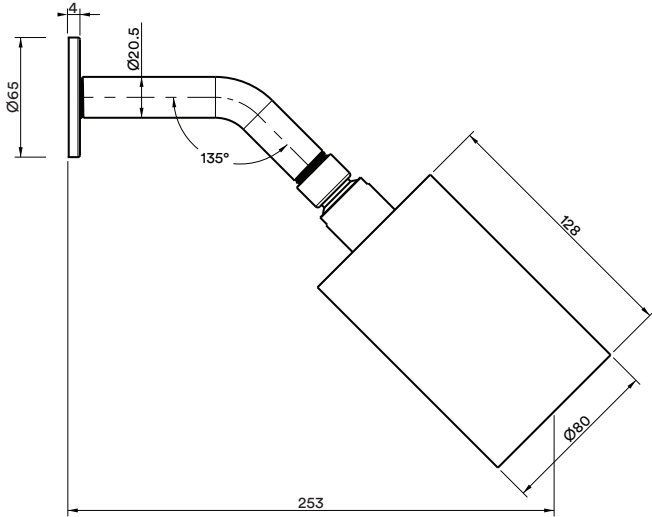

PRODUCT



DETAILED ASSEMBLY

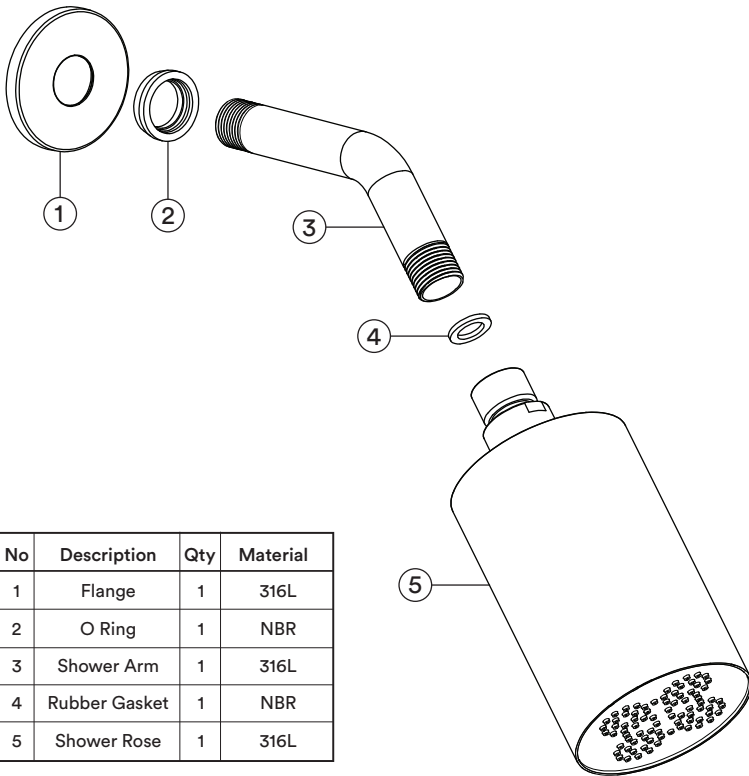

| No | Description | Qty | Material |
|----|---------------|-----|----------|
| 1 | Flange | 1 | 316L |
| 2 | O Ring | 1 | NBR |
| 3 | Shower Arm | 1 | 316L |
| 4 | Rubber Gasket | 1 | NBR |
| 5 | Shower Rose | 1 | 316L |

FEATURES

- 15 year warranty.
- 316 stainless steel.
- Flow rate: 9 Litres per minute @ 3 bar pressure.



WARRANTY

Refer to joansa.co.za for warranty terms & conditions.

CARE

Preparation:

Apply copper slip lubricant to prevent seizing of threaded fasteners.

Cleaning:

- Remove dirt using clean water and a soft cotton cloth.
- Clean the stainless steel surface with:
 - Gentle liquid detergent.
 - Colourless glass cleaner.
 - Non-abrasive polishes.
- Dry and remove all cleaning material with a soft cotton cloth.

CERTIFICATION

JASWIC APPROVED.
SABS TESTED & APPROVED.

FLOW RATE

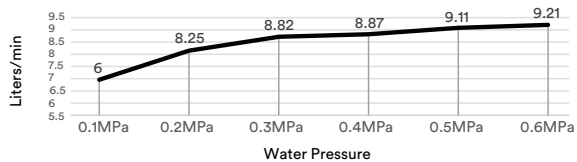

Joan
Stainless Steel
with a conscience

+27 (021) 510 0489
30 Royal Road, Maitland,
Cape Town. 7405. South Africa